

Install Zero Reveal Tapes Prior to Window Installation

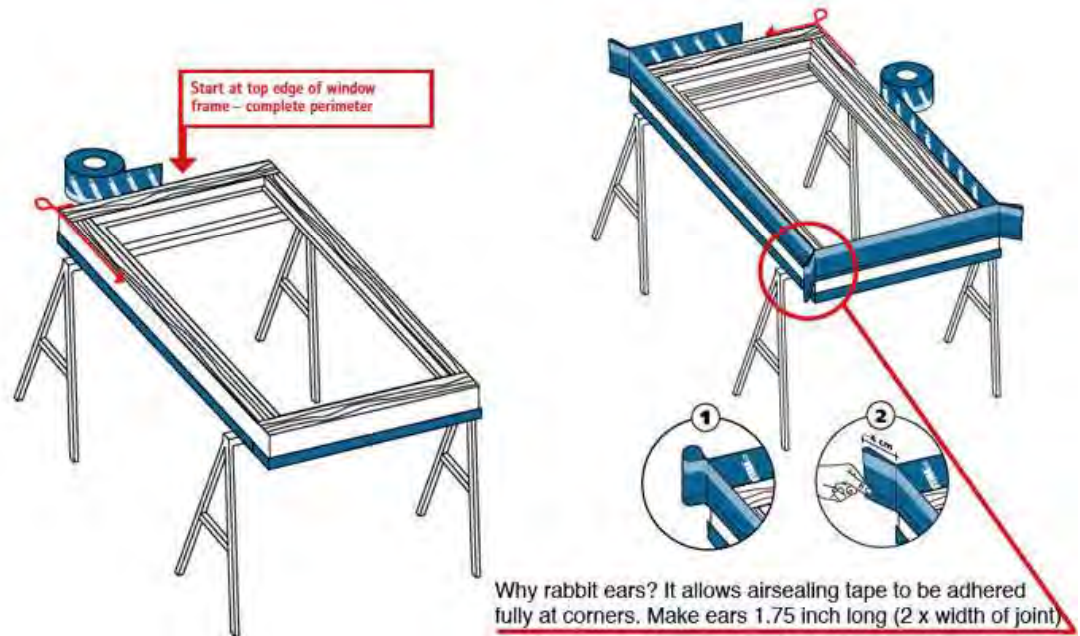

Removable tape in sequence after each side

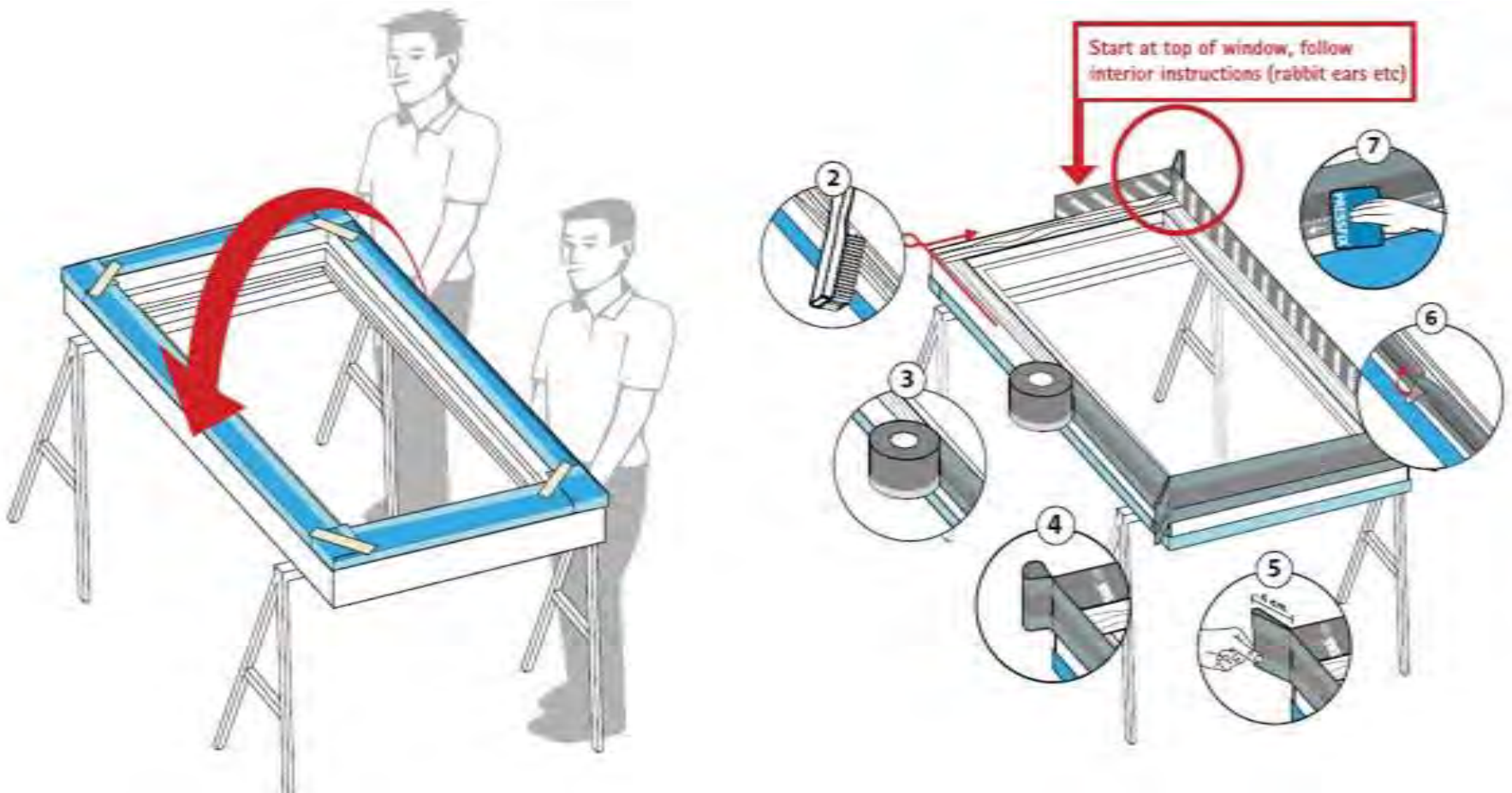

Prep Opening

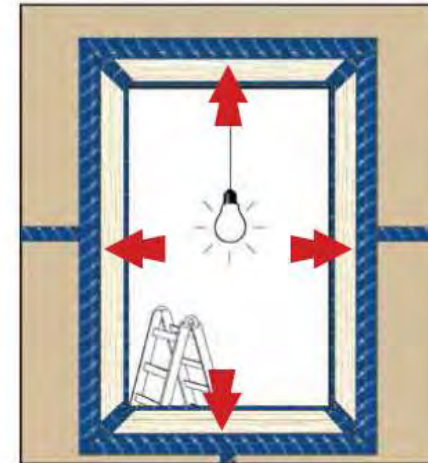

Can't tape to dust



Not frozen over



Airsealed buck joints



Grease/oil free



Swept clean

Sill is first

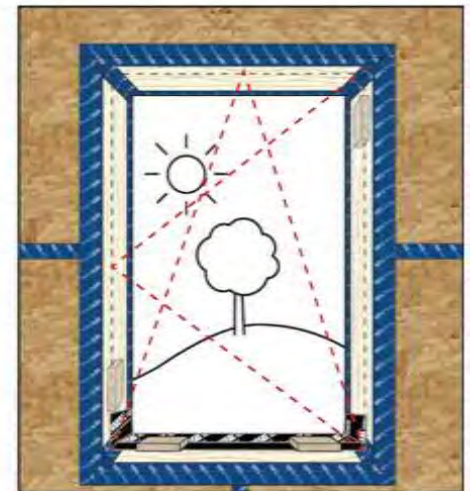
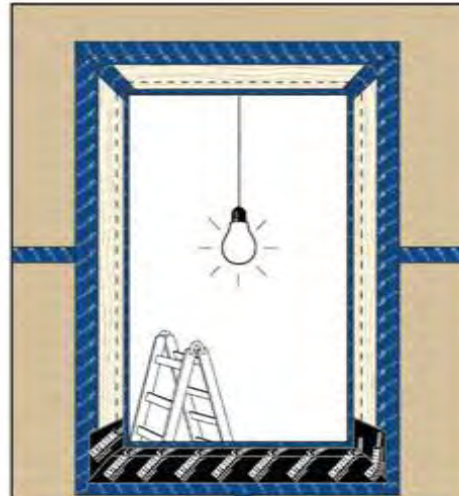

Install window frame (without sashes)

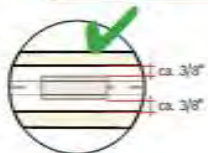
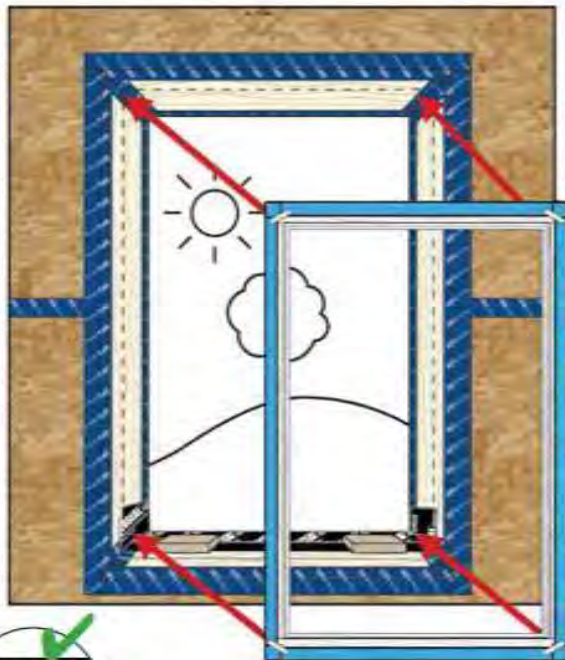

Use installation blocks from hard wood or plastic below windows that can carry load of frame and don't stick out from under frame.

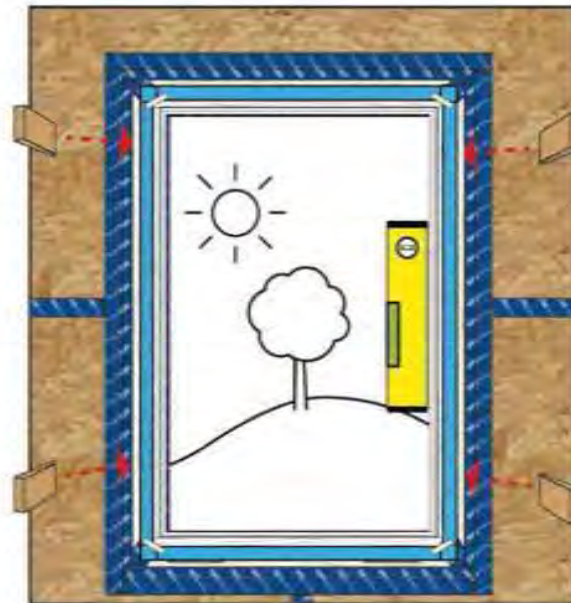

Mounting: shims and blocks.

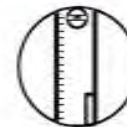

plumb

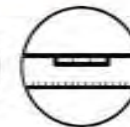

level

Shim and secure

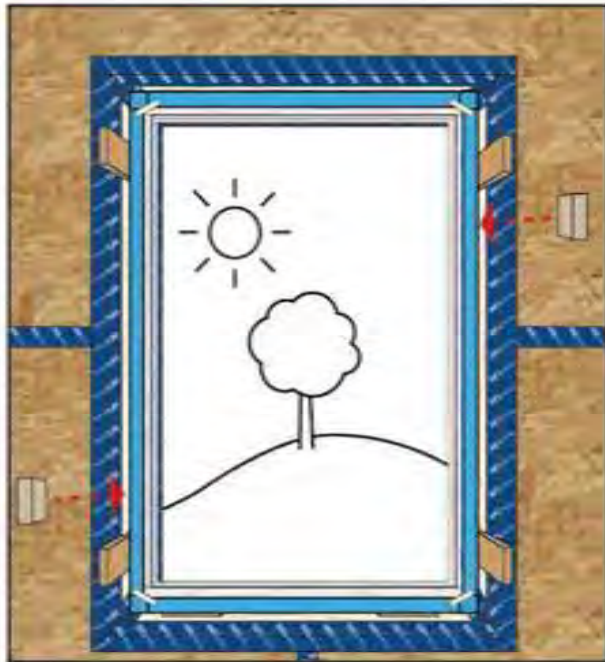

Use shims on sides to level and plumb window.
They will help carry loads from window to structure.

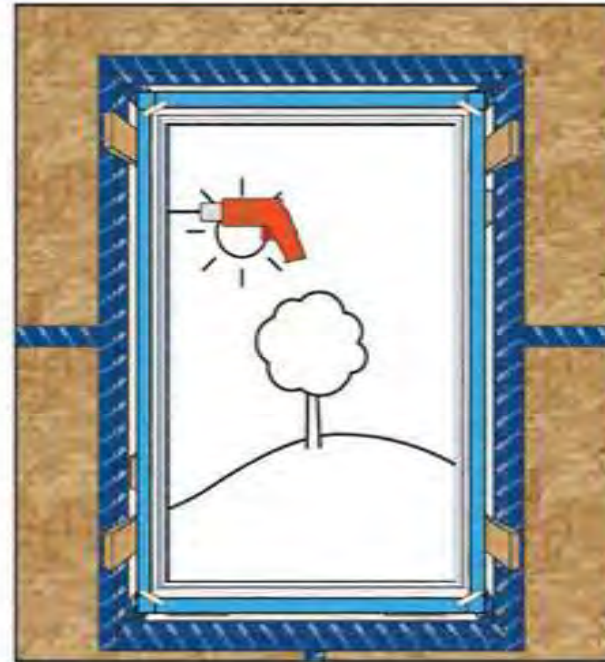

Secure windows with manufacturer recommended hardware
Trim off shims

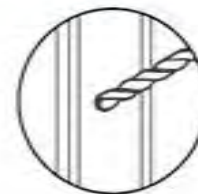

Drill



Secure frame with Screws

Connect one side, insulate, then connect the other.

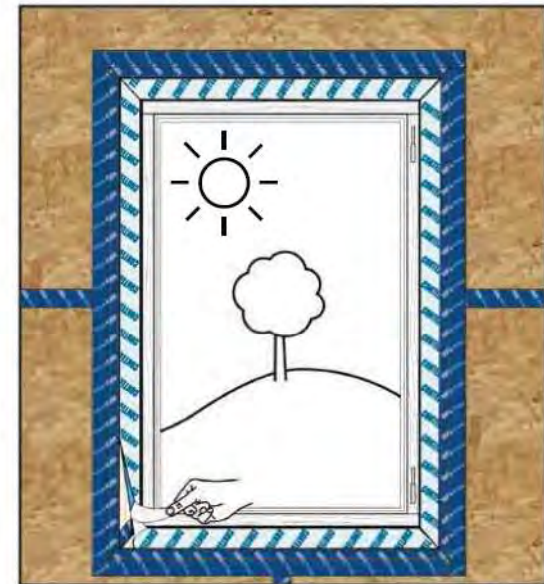

Remove release paper, bit by bit and press down tape



pressurize w PRESSFIX



Adhered corners and overlaps with CONTEGA HF



Create room for expansion joint with the tape



Insulate before connecting opposite side.

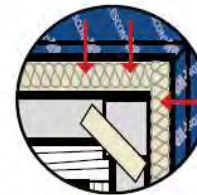
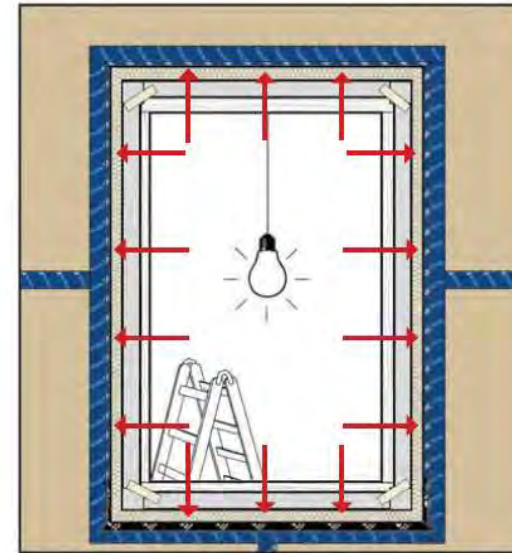

Joint should be fully filled without cavities in insulation

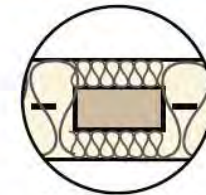

Over insulated mounting blocks

PROF-TIP:

If you folded over the tape and used temporary tape to hold it down this step is much easier.

Face taping - Inside Corners



Step-by-Step

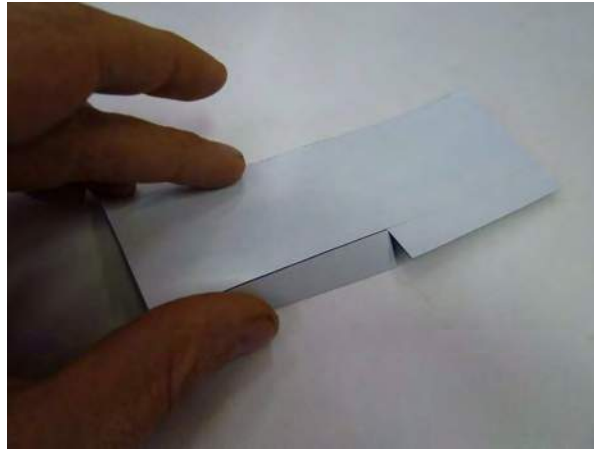
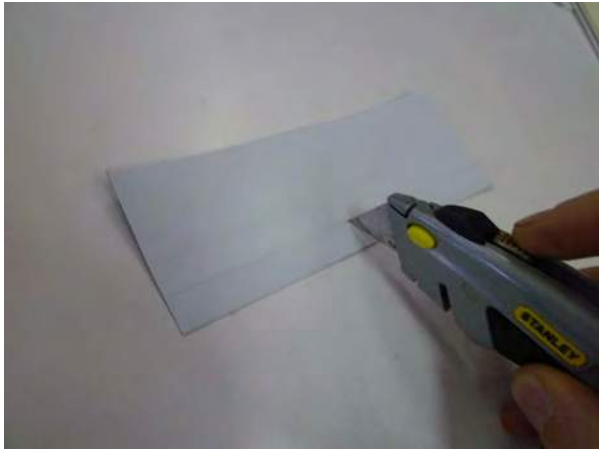

now what needs to happen?



...verify connection to inboard air barrier. To be installed? Sheathing? If sheathing, how do those framing joints work?

Flange Taping

*NOTE: To complete airtightness add tape at sill and head locations as noted below

1. Install Sill Tape
2. Install Window
3. Install Tape at Bottom Flange
4. Install Tape at Exterior Jamb Flanges
5. Install Tape at Head Flange
6. Install Tape at WRB/Head
7. Insulate gap.
8. Install interior jamb tape.

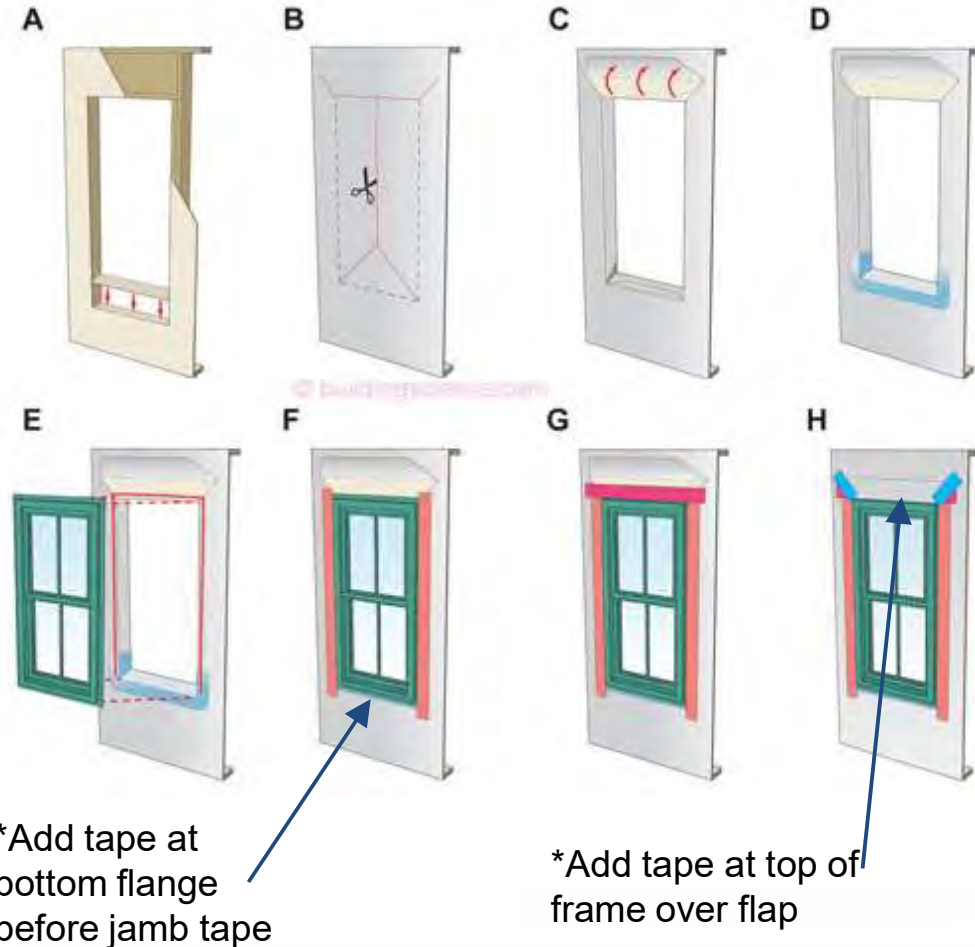

Flange taping



Connecting to concrete



Connecting to rough masonry



Over-insulate frames where possible.



Intermediate materials?

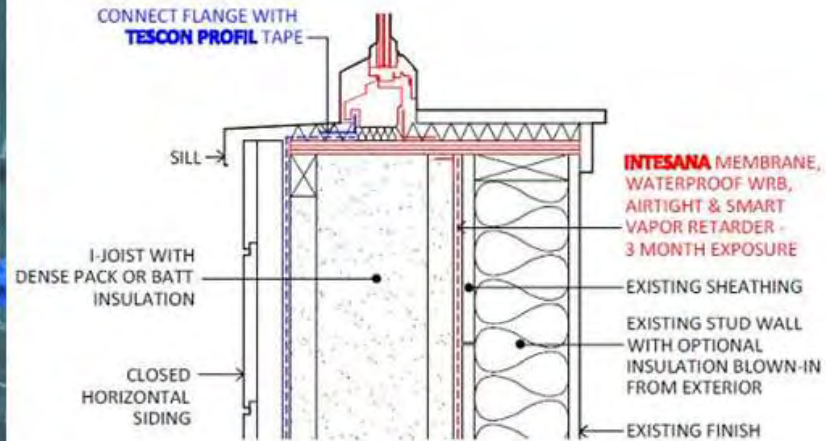

Make sure there are no holes!



Sill Taping



wriling pics???

Don't vapor dam...



Back dam



Credit: Steven DeMetrick Construction

...then up the jambs



Credit: Steven DeMetrick Construction

don't forget to tape window clips



Other sill conditions

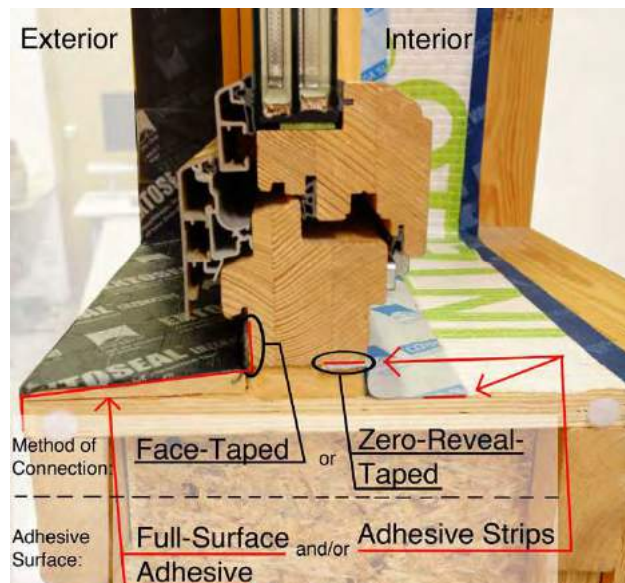

Face tape at sill



liquid sill flashing possible - material compatibility must be verified

Verify airtightness with testing



OFF SITE





Summary

- **High performance is based on the robust continuity of control layers; of insulation and inboard and outboard air and vapor control.**
- **Careful planning and execution, including; material selections, simplification and sequencing is critical.**
- **High performance is only assured with a blower door test, repair and verification.**



Break





Mock-ups





Thank you

